

A project by



SAANVI
INFRA PROPERTIES

SAANVI AASTHA



2 & 3

BHK Luxury Apartments @ Alkapuritownship, Road No.20



2 & 3 BHK Luxury Apartments @ Alkapur town ship, Road No.20

AMENITIES & FEATURES

- Quality Construction
- Strategic location
- Excellent Ventilation
- 100% Vaastu
- Individual flats
- Solar-Fencing
- CCTV
- Intercom Facility
- Power backup generator

SAANVI
AASTHA



NORTH FACING
Flat No.3



EAST FACING
Flat No.2



EAST FACING
Flat No.1



TYPICAL FLOOR PLAN



AREA STATEMENT

FLAT NO.	1	2	3
UNIT	3 BHK	2 BHK	3 BHK
AREAS IN SFT.	1652	1275	1643



STRUCTURE :
R.C.C. Framed structure

SUPER STRUCTURE :
First Class Brick work in Cement Mortar

PLASTERING :
Plastering in two Coats sponge finish

UTILITIES :
Provision for Exhaust fan, Chimney,
Washing Machine

TELECOM :
a) Intercom facility to all the Flats
connecting the security
b) Provision of Internet connection in
Master Bedroom and drawing room

WATER SUPPLY & SANITARY :
ISI Mark CPVC piping executed
by professional Plumbers

CCTV Camera Provision :
CCTV cameras will be provided
to enhance the security feature.



DOORS :
a) Main Door: Best Teak Wood
Frame and shutter finished with
Teak Ply/Teak Veneer, aesthetically
designed with melamine polishing
and designer hardware of reputed
make.
b) Internal Doors : Teak Wood Frame
and designer Skin molded doors with
enamel paint with standard fittings

BATHROOMS and TOILETS :
a) CP fittings of SOMANY/JAQUAR/
HINDWARE or equivalent make
b) EWC and flush tank of SOMANY/
CERA/HINDWARE or equivalent make
c) Hot and Cold provisioned wall
Mixer with Shower
d) Tiles up to 6.6' Height
e) Ceramic non slippery flooring of
Standard Make

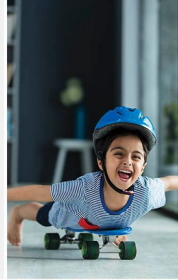

WINDOWS :
UPVC Windows of Aparna/Wintech
or equivalent make

PAINTING :
a) Internal: Smooth luppam/putty
finish with premium acrylic emulsion
paints
b) External: Combination of Premium
Texture/Cement based Painting

LIFT :
6 Passenger capacity lift of KONE
or equivalent make with Granite/
Vitrified tile Cladding

GENERATOR :
Power backup Generator of
Mahindra or equivalent make with
backup for common Areas, lift, 3 fans
and 3 tube light points in each flat



SPECIFICATIONS



ELECTRICAL :
a) Concealed copper wiring in conduits for lights, fan, power
plug points of FINOLEX/KEI or equivalent make
b) Power plug points for cooking range chimney, refrigerator,
micro - ovens, mixer grinder in kitchen
c) Power outlets for air-conditioners in all Bedrooms
d) 3 phase supply for each unit with individual meter board
e) Power outlets for Geysers in all bathrooms
f) All Modular electrical fittings of Legrand or equivalent make
g) Plug points for TV. in Drawing room and Master Bedroom
h) MCB for distribution board of Legrand or equivalent make.

KITCHEN :
Municipal and bore well water
connection provision for Aqua guard

FLOORING :
Vitrified tiles of size (800X800mm) of
Johnson/Varmora or Standard make

SOLAR FENCING :
Solar Fencing will be provided across
the building

WATER :
Water Harvesting Pit will be provided

HARVESTING PIT

NOTE :
a) Person desires to Alter/Modify their
flat internally shall be done at extra
cost only.
b) Person desires to Alter/Modify their
flat internally need to be informed
before the brick work.
c) Shelf's, Lofts, Chajja's and extra
electrical points are optional with extra
cost.
d) GST and Registration charges as
applicable to be borne by the purchaser
only as per the prevailing rates.

PARKING PLAN

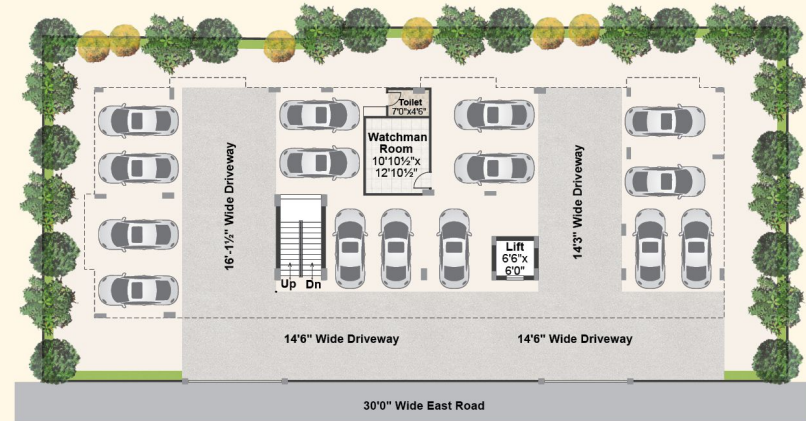

LOCATION MAP (NOT TO SCALE)

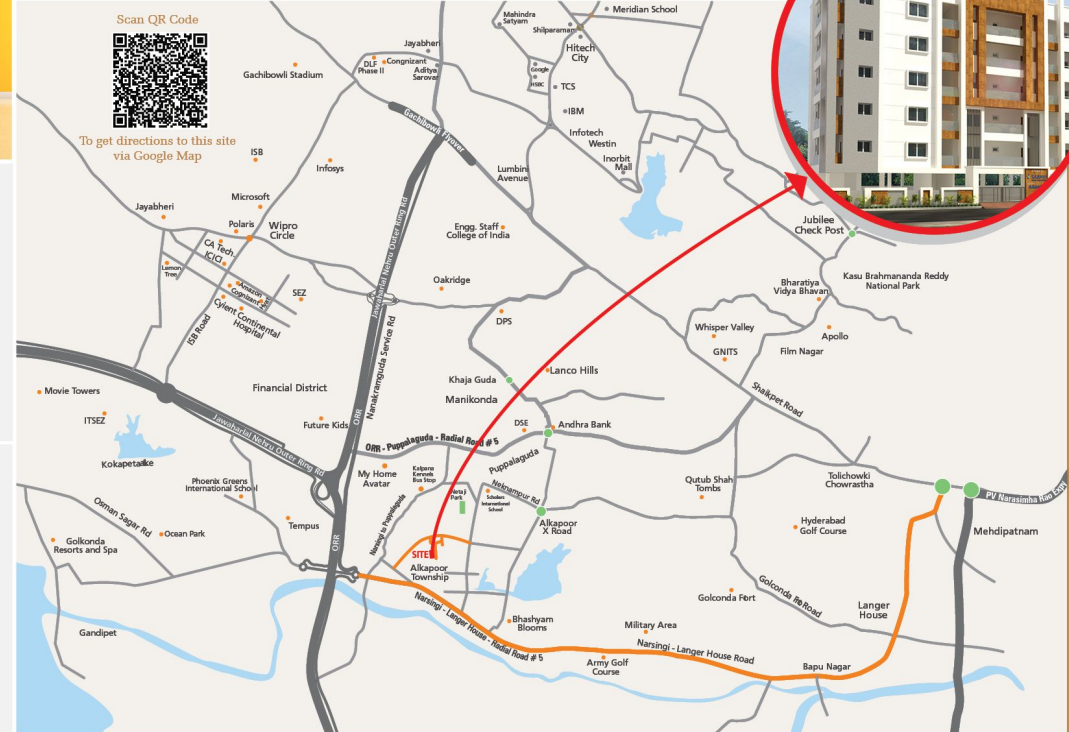

PROMOTERS



Flat No. 601, Lotus Homes, A-Block,
Sector-1, Alkapuritownship,
Neknampur (V), Hyderabad,
Telangana - 500089.

Email ID : sales@saanviinfraproperties.com
koteswara@saanviinfraproperties.com

Call : +91 99084 80222.

Architects

ARC & ARCHITECTURE
Architects & Interior Designers

No. 8-2-608/27, Fourth Floor, Mastan, Mansion, Road No. 10,
Lane Beside Mandir Showroom, Banjarahills, Hyderabad.
Ph.No.:9885602620,7799895983.
e-mail : arcnarchitecture@gmail.com pasupathi29nath@gmail.com

NOTE : This brochure is only a conceptual presentation of the project and not a legal offering.
The promoters reserve the right to make changes in plans, specifications and elevation as deemed fit.